

Mega-Melville® Plus Steps



Mega-Melville® Plus Steps



	Dimensions (mm)	Dimensions (in)
	180 x 406 x 1219	7 1/16 x 16 x 48
Weight/unit	203 kg	447 lb
Length/cube	7.31 lin. m	24 lin. ft
Qty/cube	6 units	3 Rows
Weight/cube	1243 kg	2740 lb

Colours

Codes	Colours
10050116	Range Scandina Grey
10050113	Range Amber Beige
10050111	Rockland Black
10050092	Range Newport Grey

Sold in full cubes only
Production location – St-Eustache

Typical row

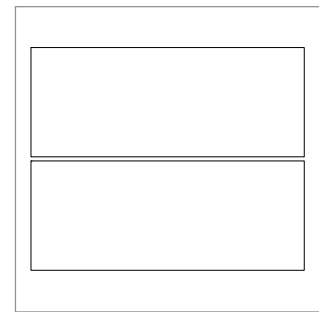

Specific Installation

TYPICAL CROSS SECTION – INSTALLATION FOR MEGA-MELVILLE PLUS, MEGA-LAFITT

- A Concrete pavers
- B Laying bed 25 mm (1 in)
- C 0-20 mm (0-3/4 in) compacted foundation
250 mm (10 in) sandy soil
400 mm (16 in) clay soil
- D Concrete step
- E Perforated drain 100 mm (4 in) Ø connected to services
- F 12 mm (1/2 in) maximum laying bed must be compacted
- G Geotextile

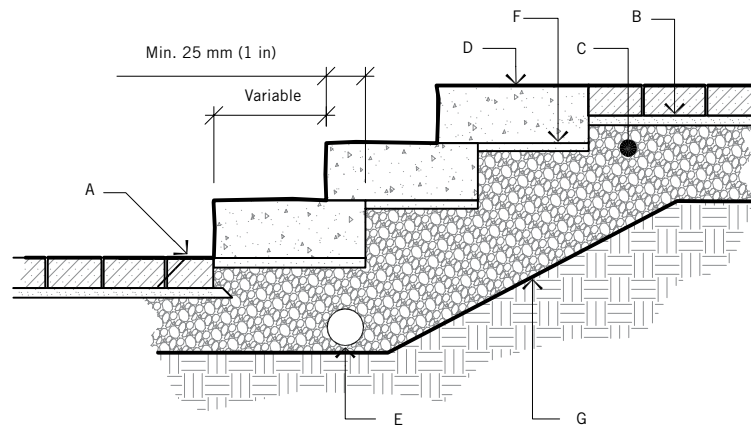

Notes

Given the high weight of this step unit, it is highly recommended to use suction-based lifting equipment for handling and placement (avoid manual installation), or specialized handling equipment such as a clamp adapted for this type of product. The Grande wall module clamp can also be used.

Additional details specific to this product are available by consulting our landscaping installation guide on our website (Steps section).